

somfy®

TaHoma® switch

Installation guide

EN

Welcome !

Start TaHoma[®] switch
in a few steps

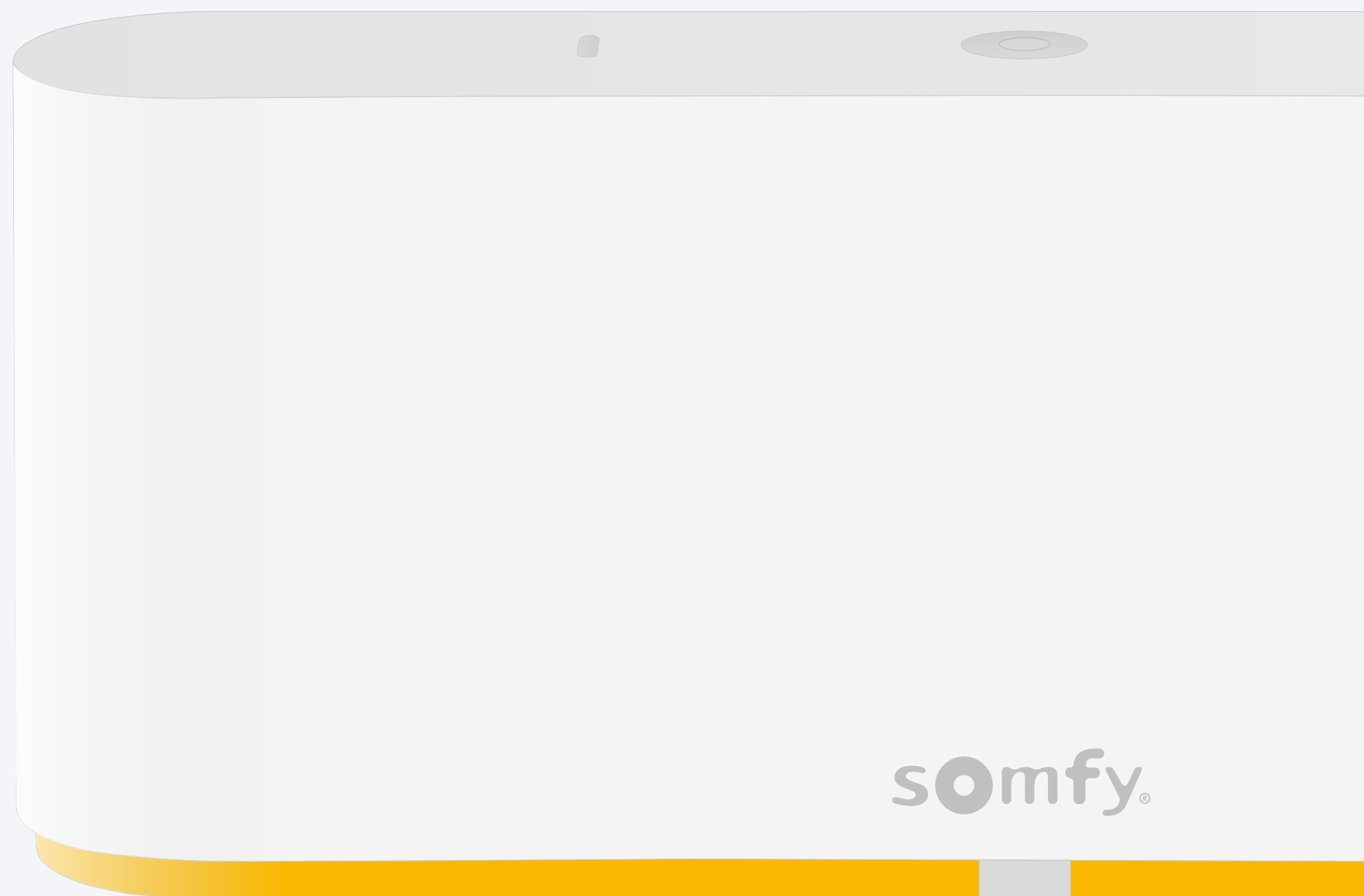

Pack content

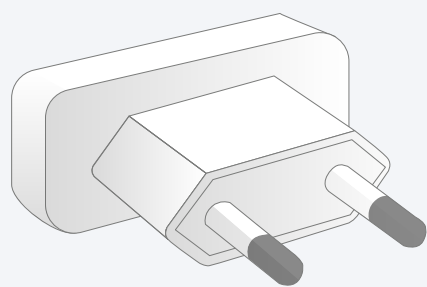
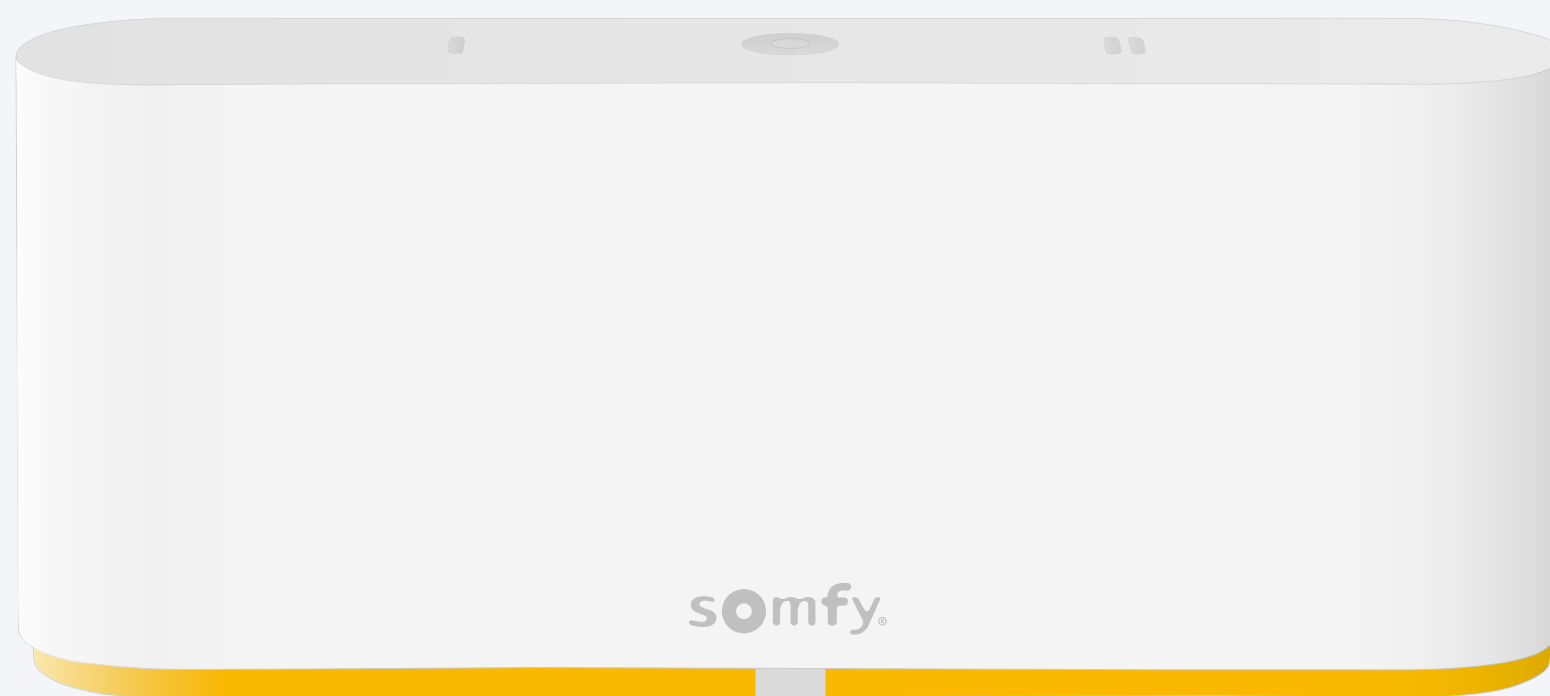

or

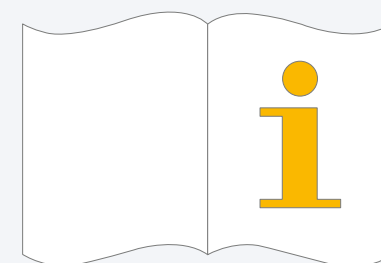
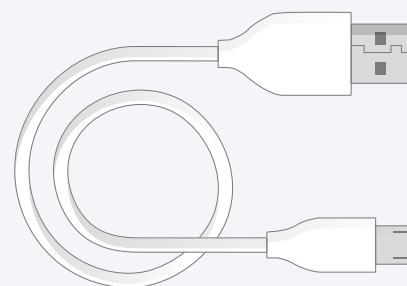
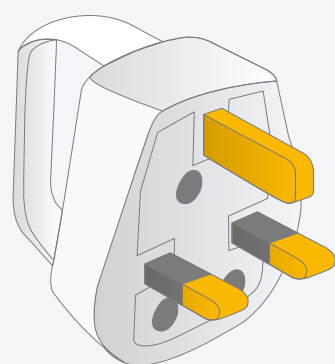

Install TaHoma[®] app



Follow instructions

TaHoma[®] installed

1. Launch TaHoma[®] app

Start

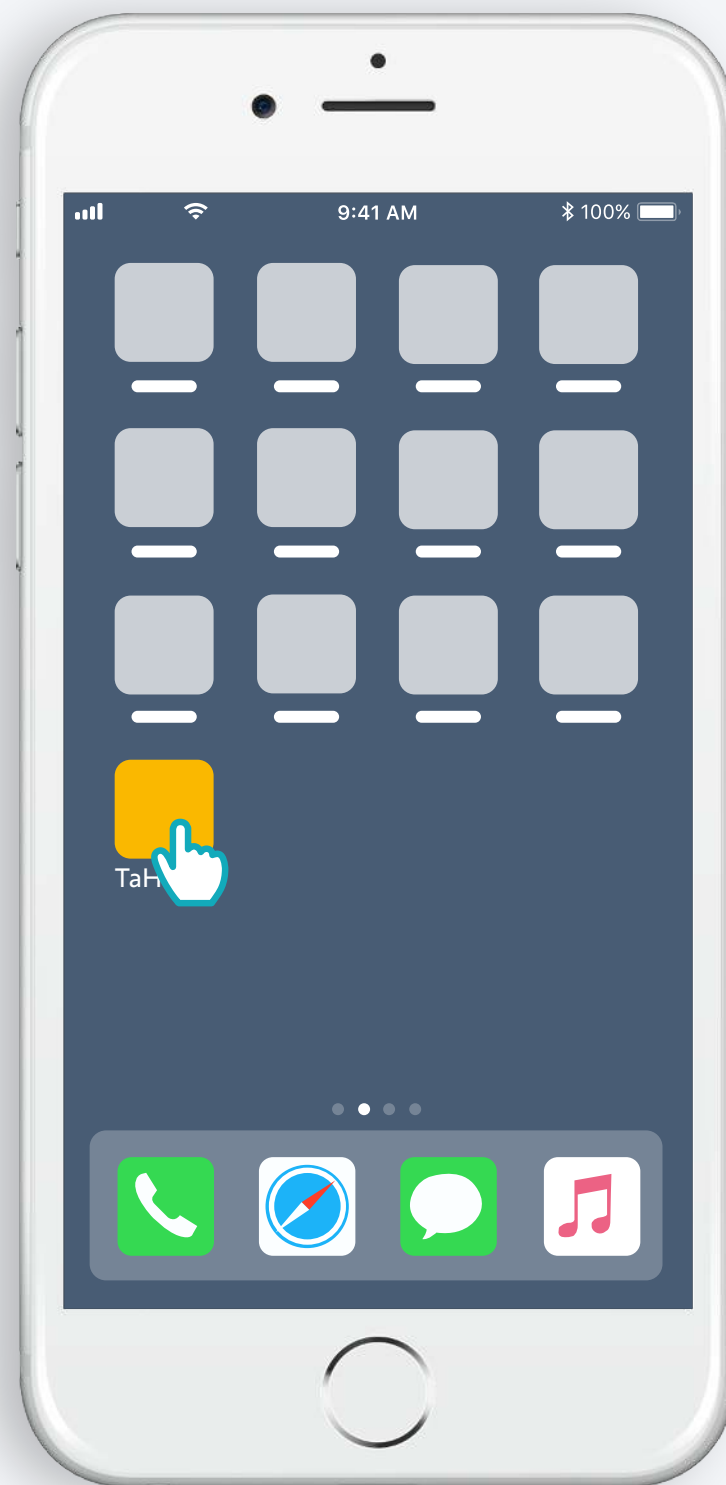

Open TaHoma[®] app

Start

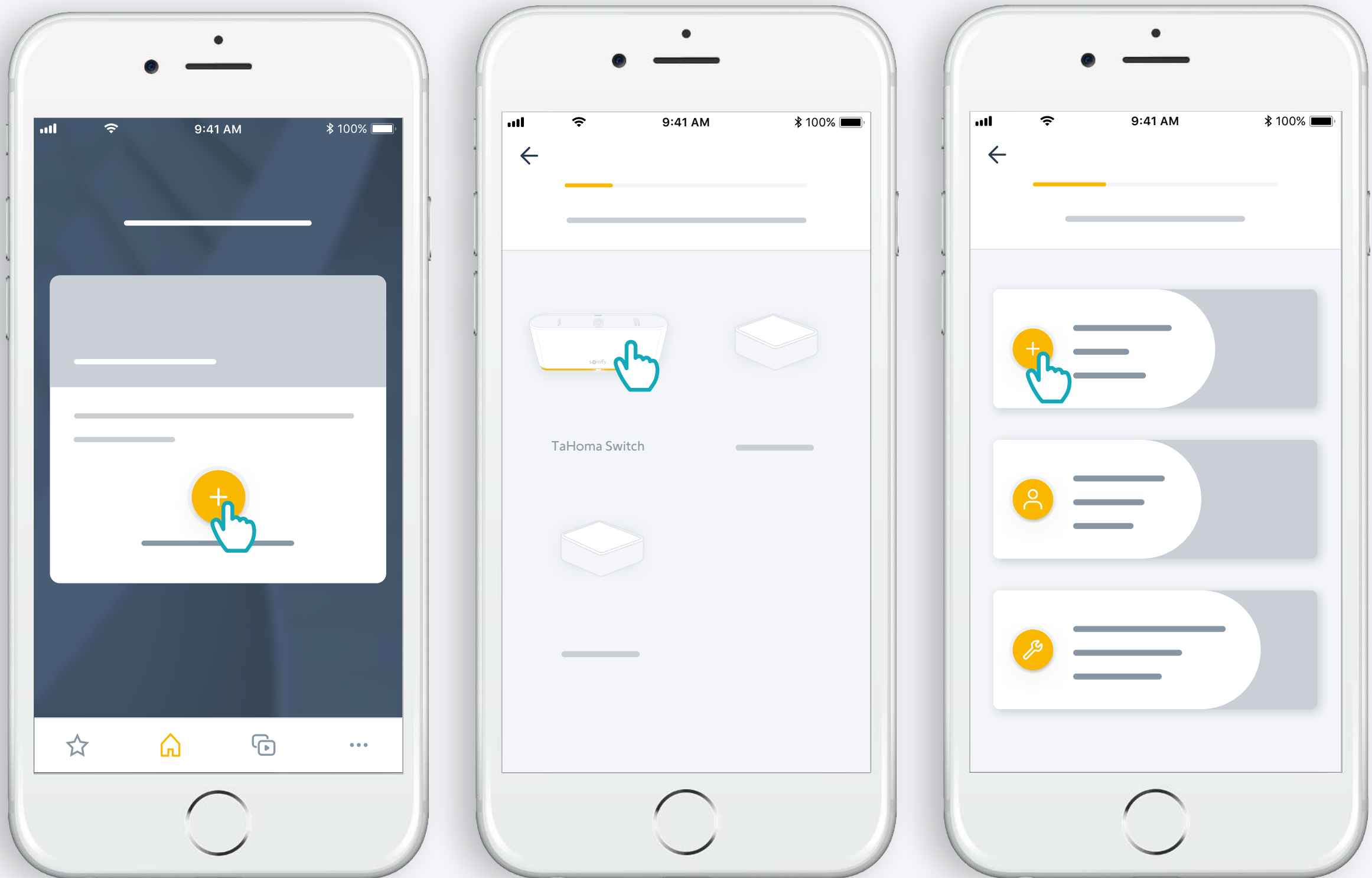

Start TaHoma[®] switch installation

Plug power supply

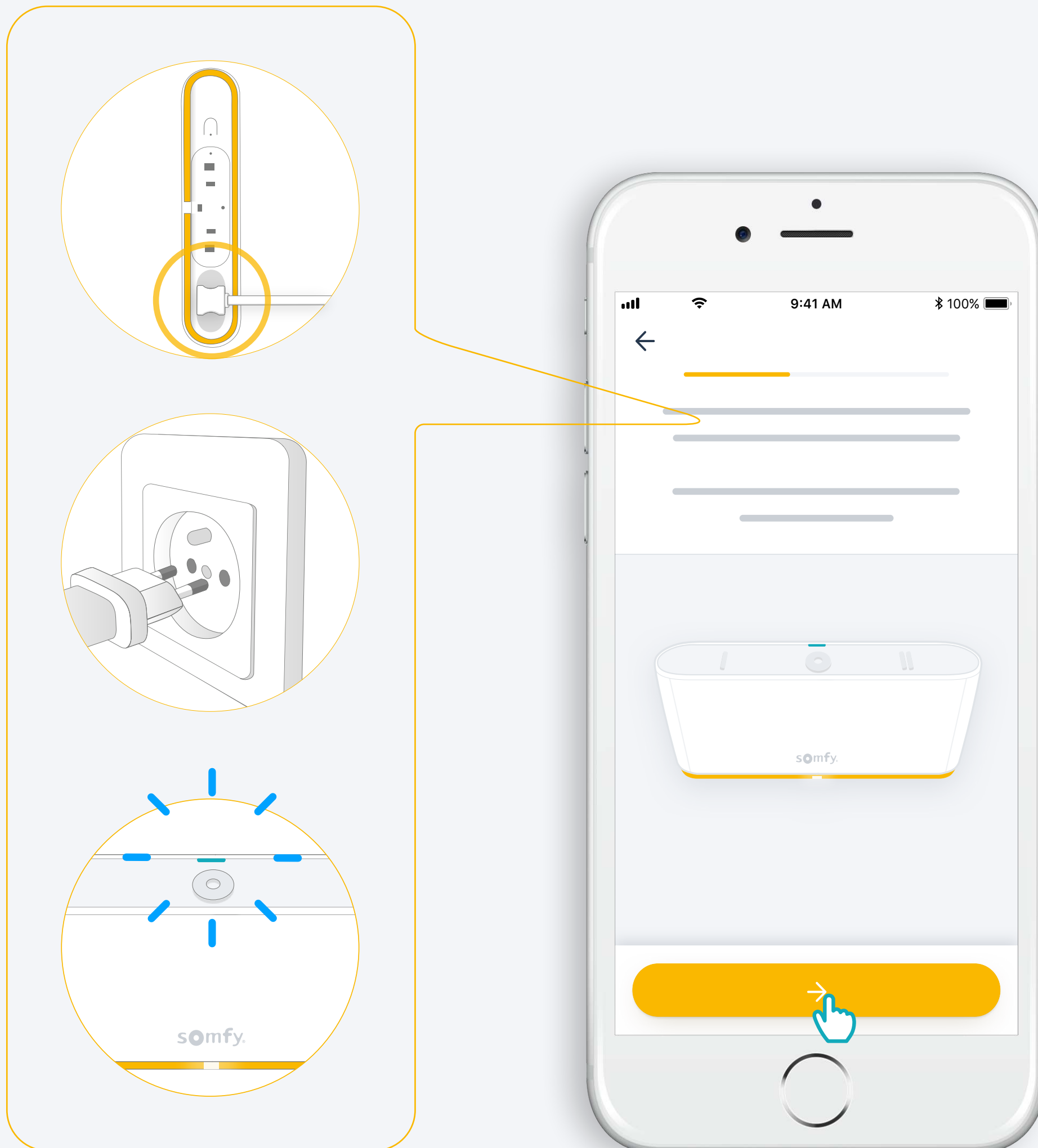

Connect to the internet

Your WiFi network must be in 2.4 GHz and secured with a password.

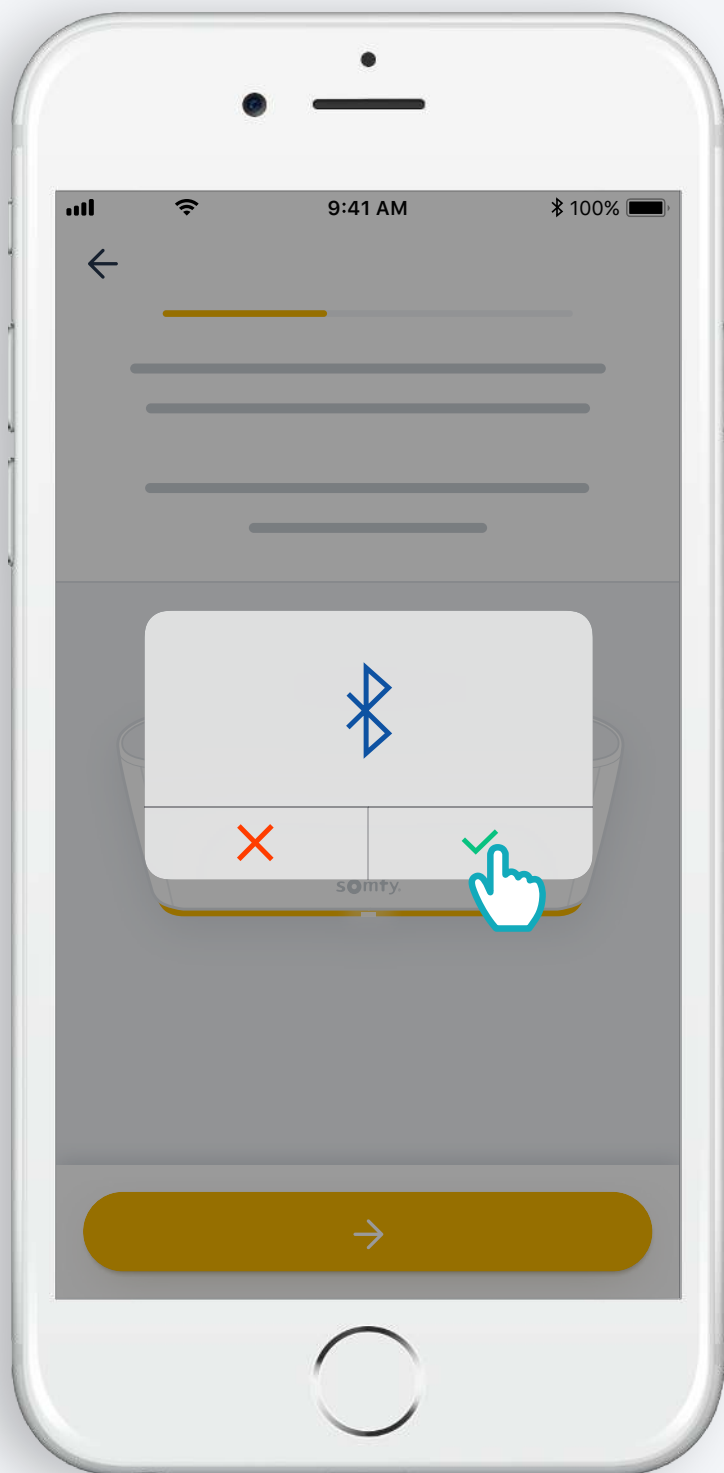

Accept Bluetooth

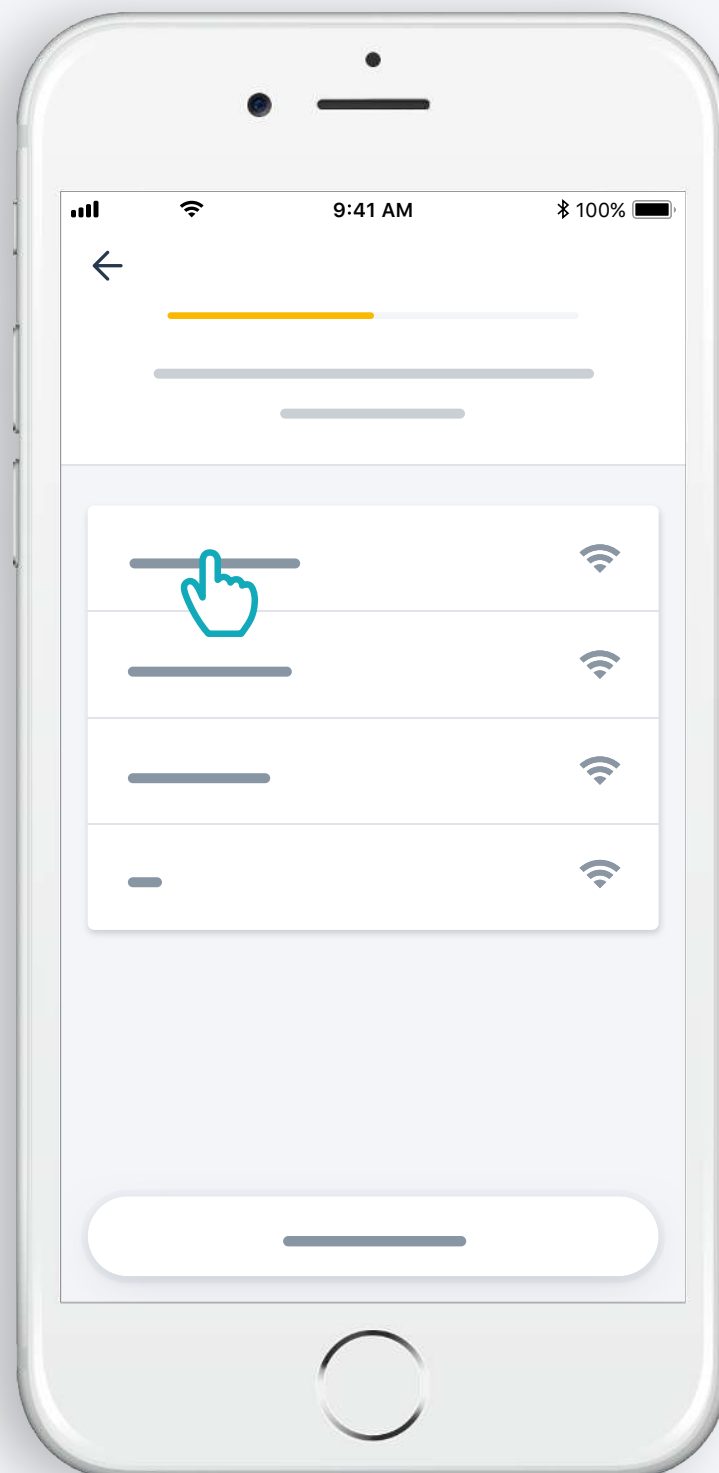

Select WiFi and enter password

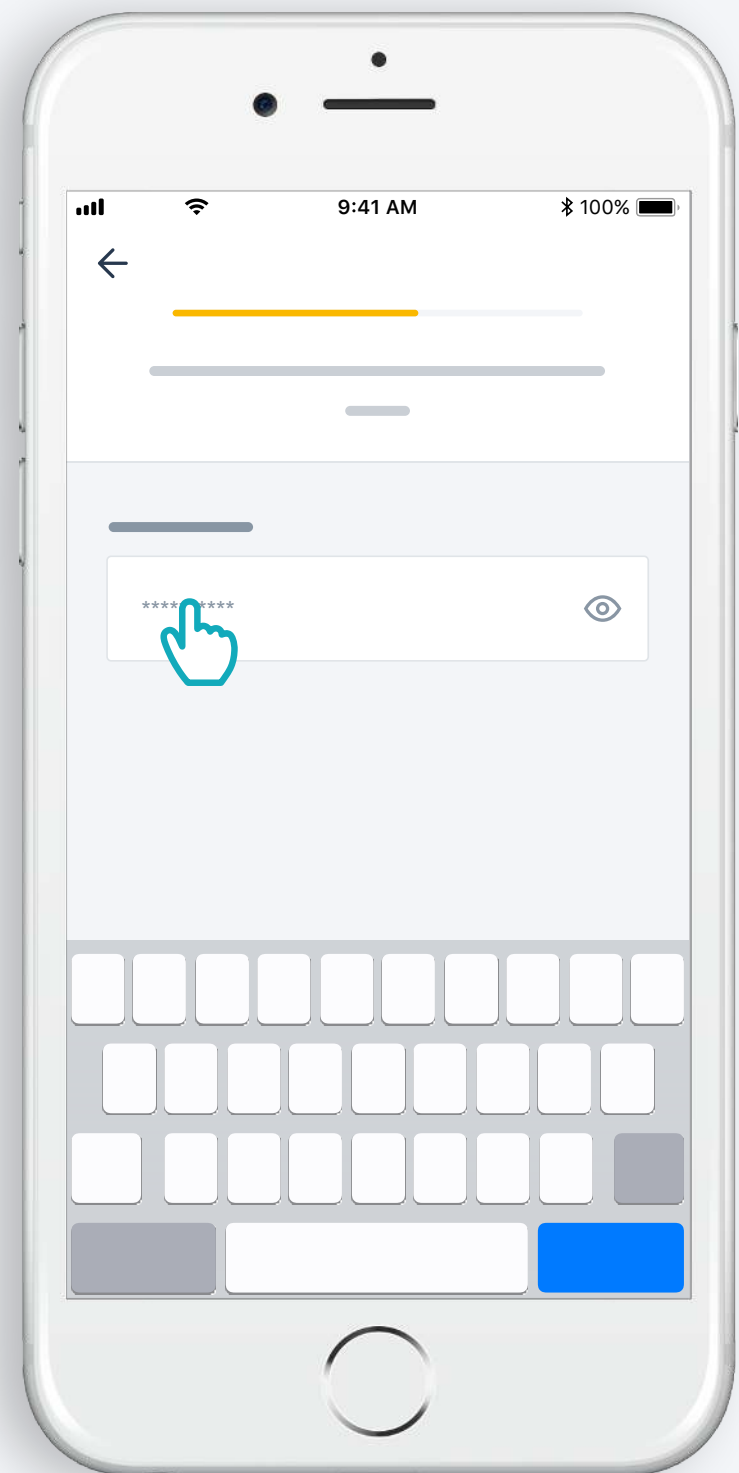

2. Create your TaHoma[®] account
or Log in

Create your TaHoma[®] account or Log in

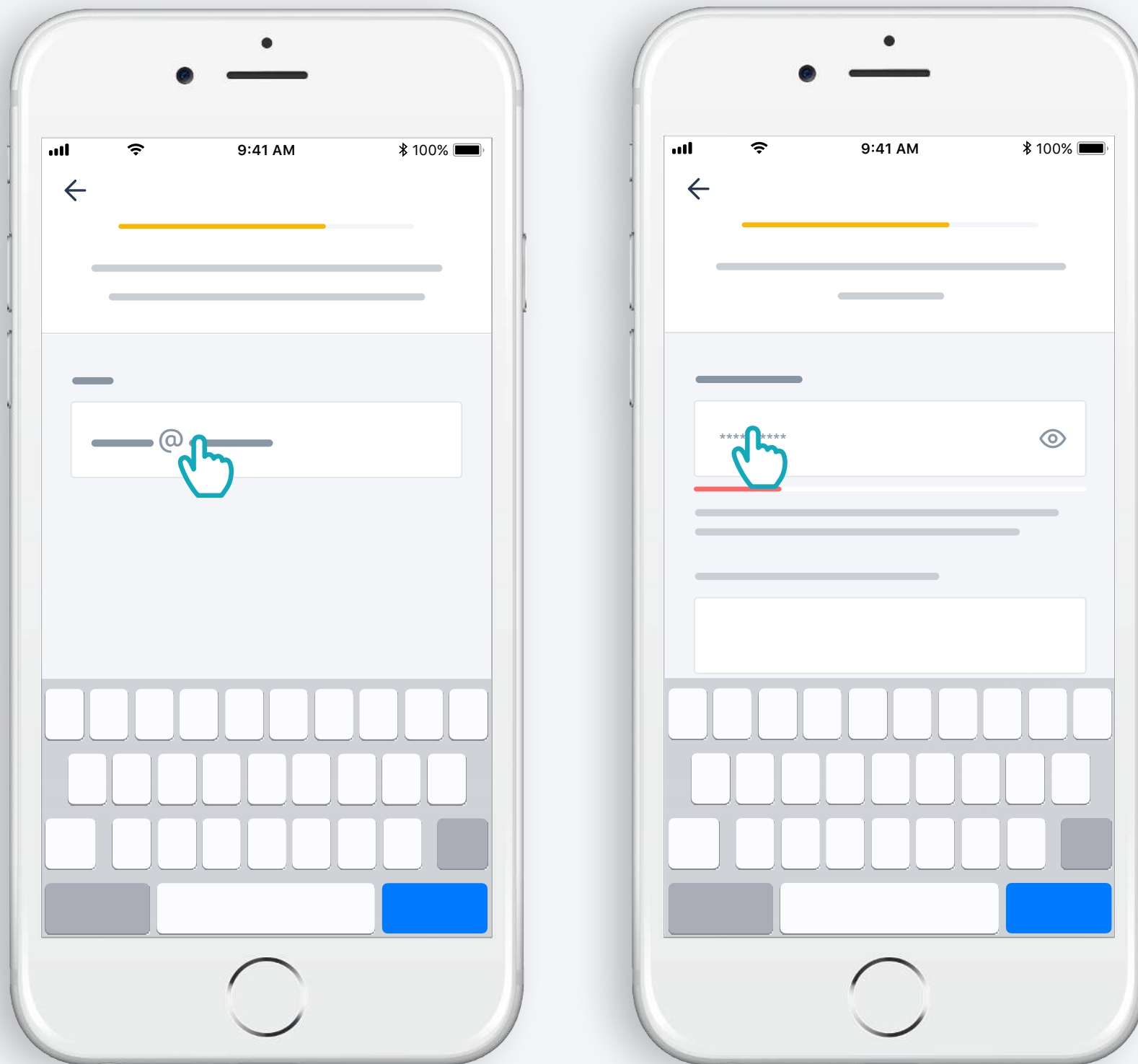

Enter your email address and password

Follow the instructions

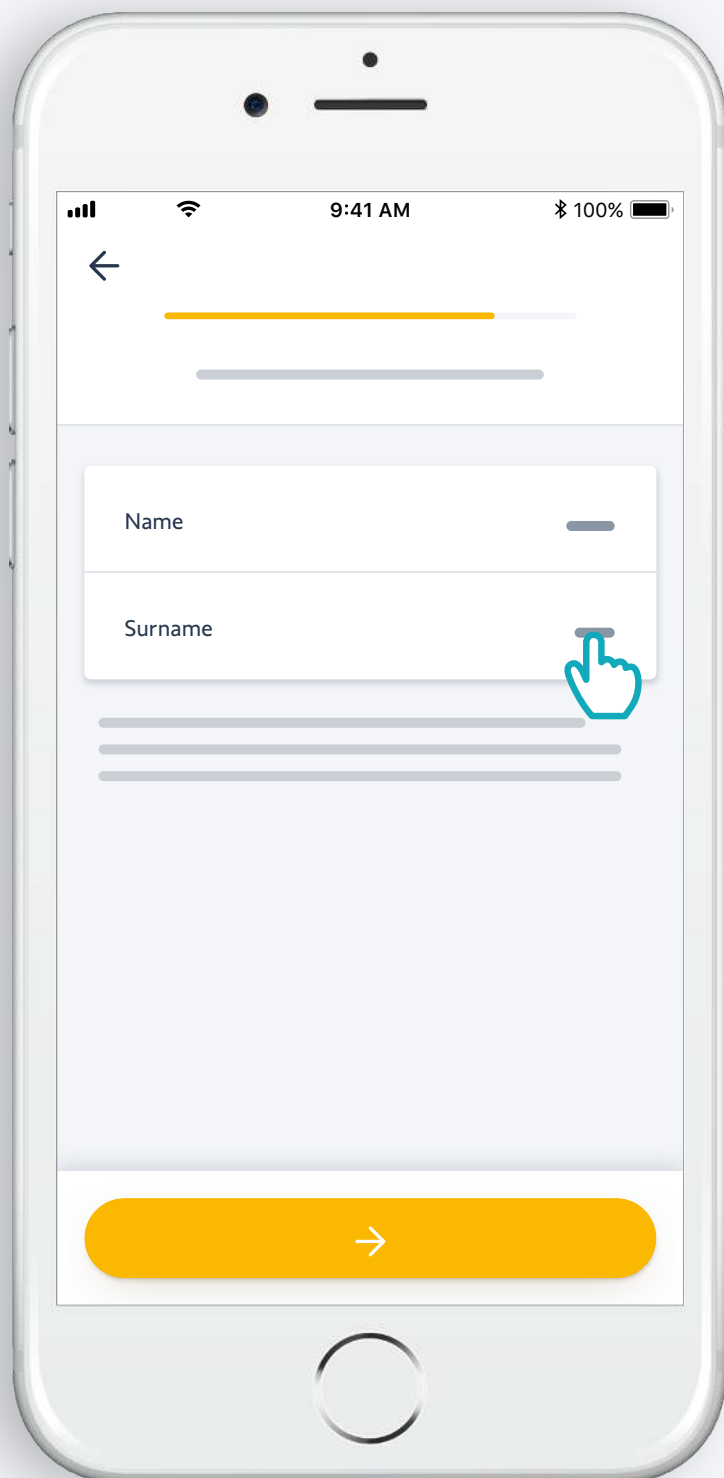

Enter your name

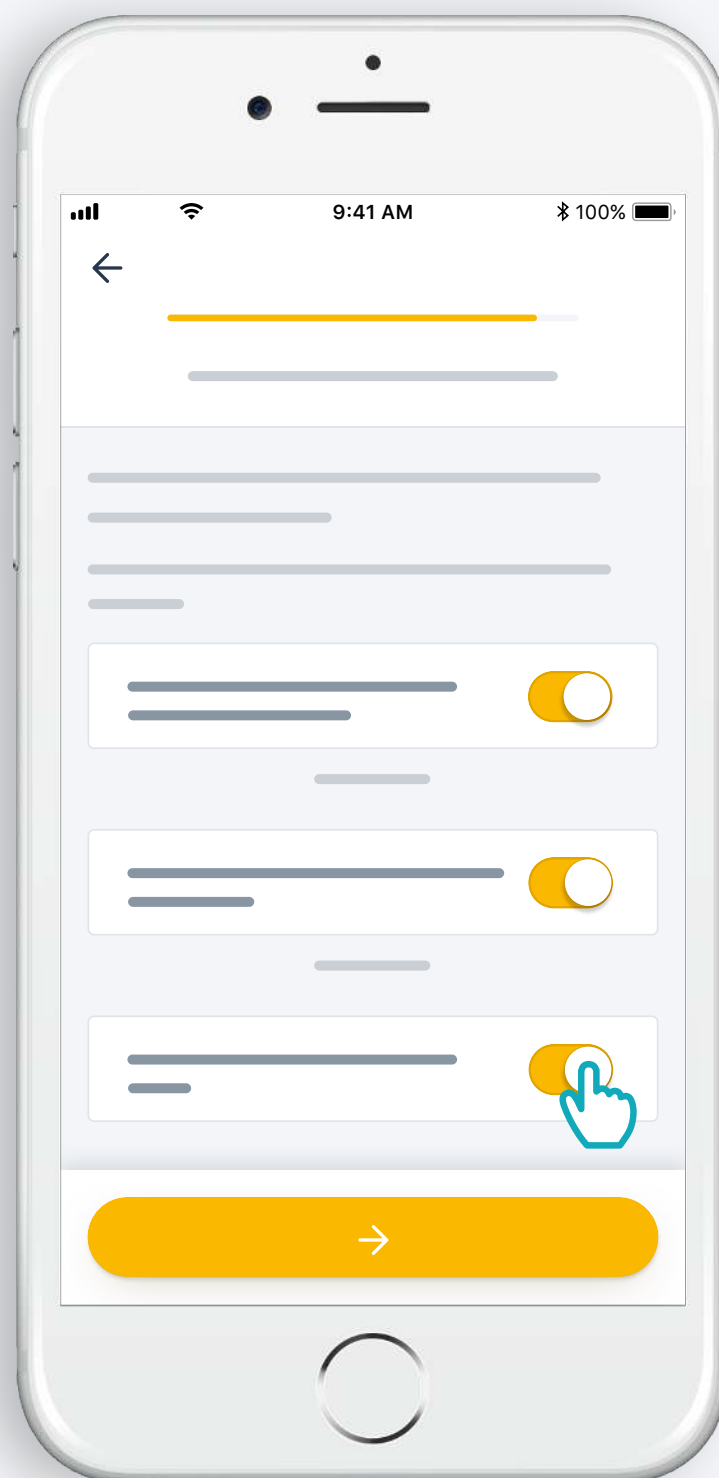

Accept Terms and
Conditions

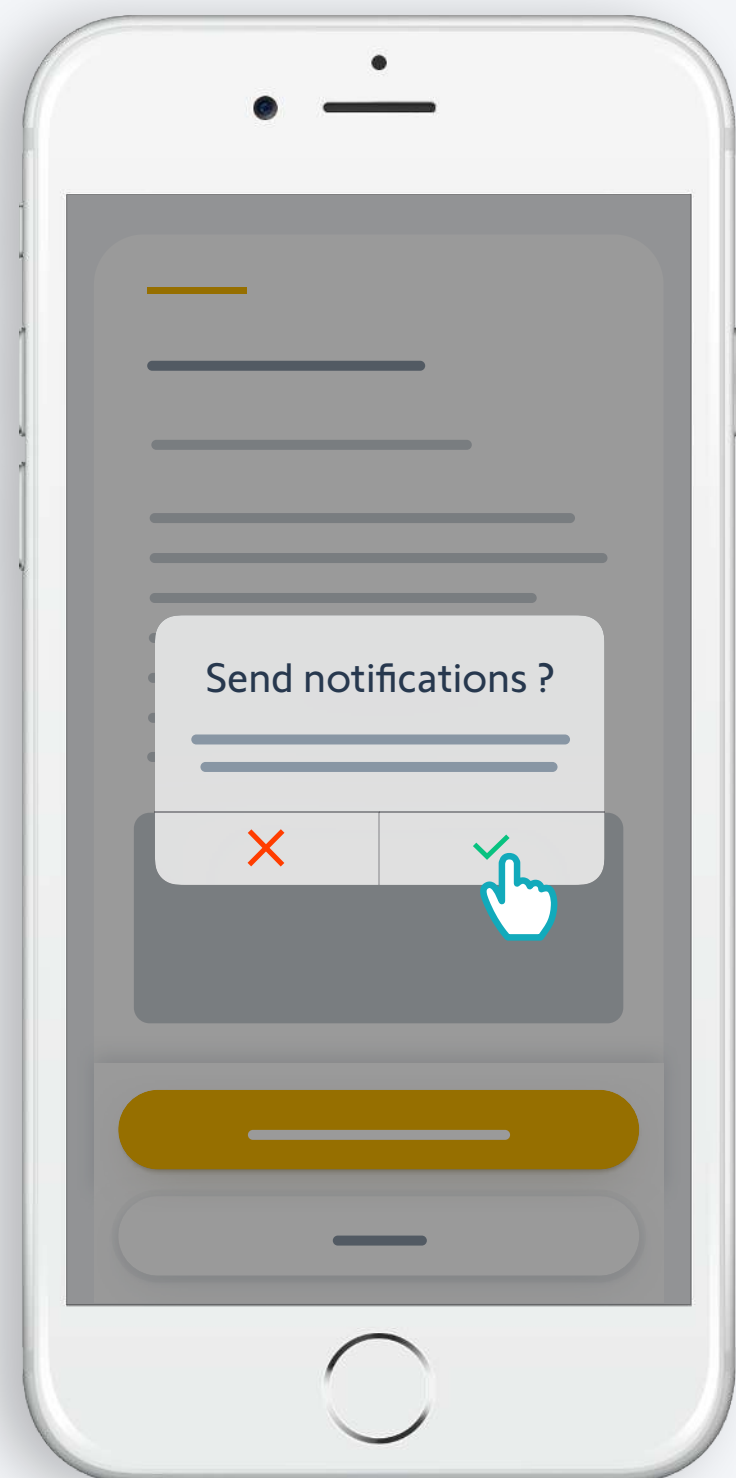

Authorize
notifications for
better experience

Congratulations,
TaHoma[®] switch is ready to use!

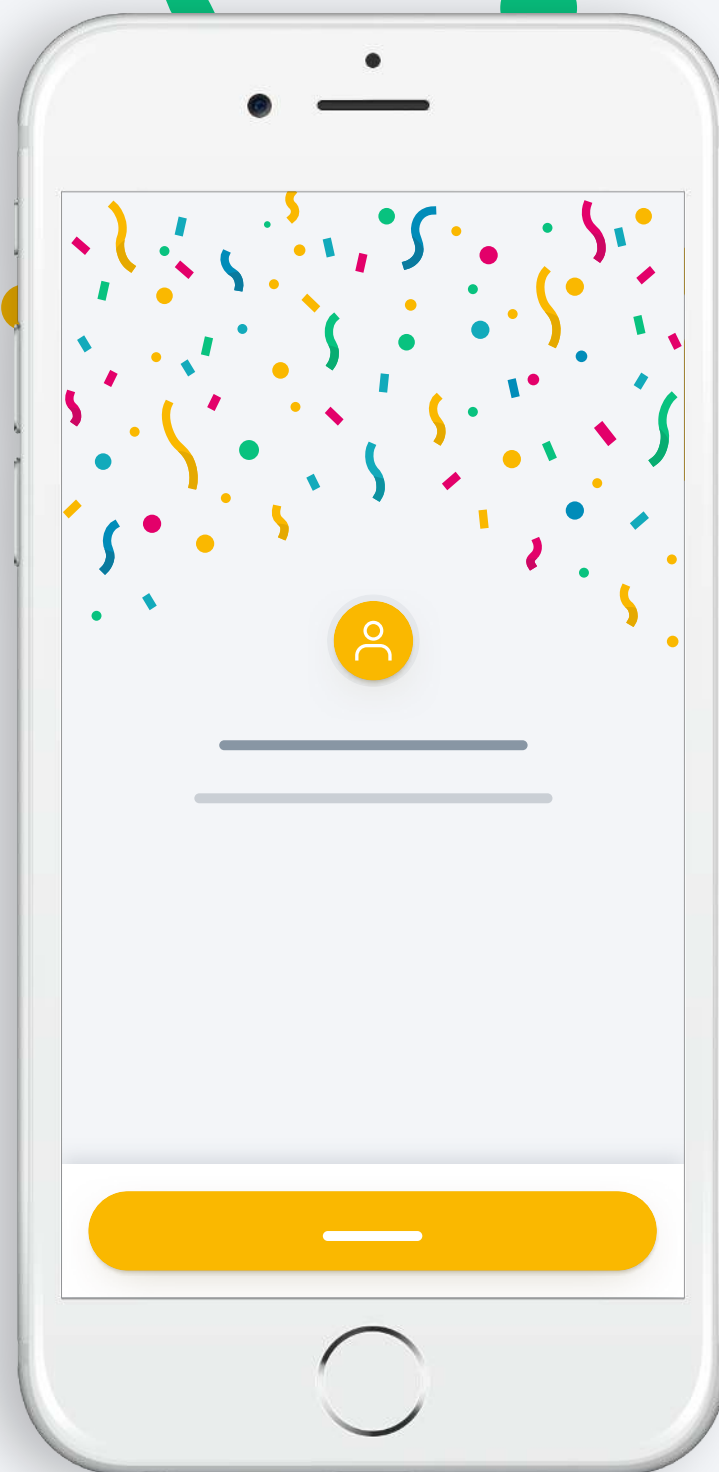

Now :

- Add products,
- Configure the buttons of TaHoma[®] switch,
- And discover all the possibilities offered by the app!

somfy®

5156700A