

Easy Adjust Bottom Rail Leveling System (Pocket & Ferrule)

Over the years Hunter Douglas Duette honeycomb shades have included pocket and ferrules that allow installers to adjust the level of the shade in the field. While functional, leveling the bottomrail (and middle rail on Top-Down/Bottom-Up shades) with pocket and ferrules is time consuming and if a ferrule breaks, it usually means re-cording the shade.

With the introduction of the Next Generation Common Headrail and the new EasyAdjust leveling system. By utilizing a "key" to make adjustments, EasyAdjust makes quick work of leveling without cords to cut or tuck. Simply insert the "key" provided with every order, into a 7/64" Allen socket and turn it, clicking clockwise to raise the rail and counter-clockwise to lower it. Two clicks adjust the shade by a little less than 1/8" up to a maximum adjustment of 2".

For EasyRise™, UltraGlide®, and PowerRise® shades *slightly raise the rail you want to level*, insert the key and turn it. Lower the rail to check the level and make further adjustments if necessary. For LiteRise® shades, you do not need to raise the rail at all, simply insert the key and turn.

Standard Cordlock shades still use the pocket and ferrule system.

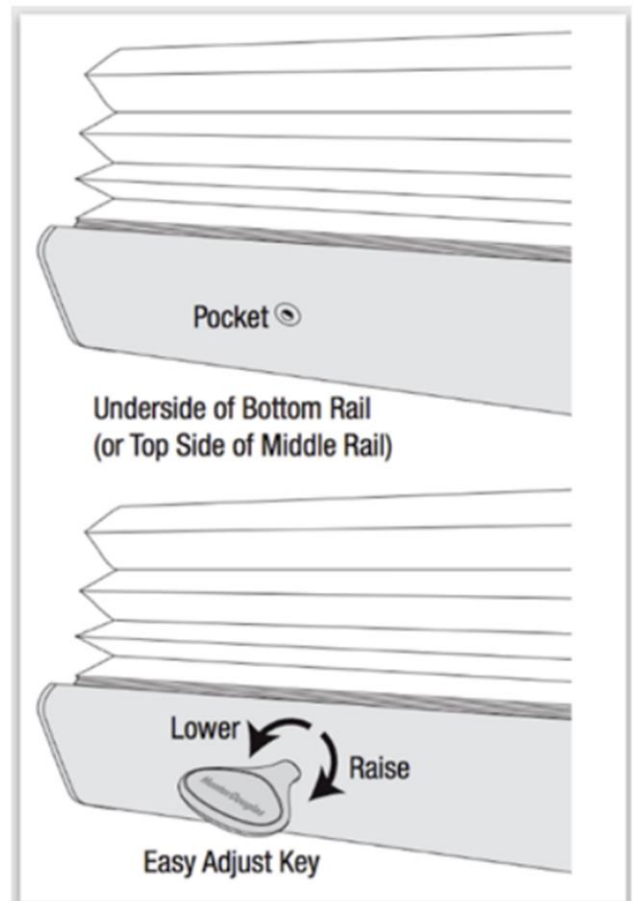

Duette® EasyAdjust™

Quick Reference

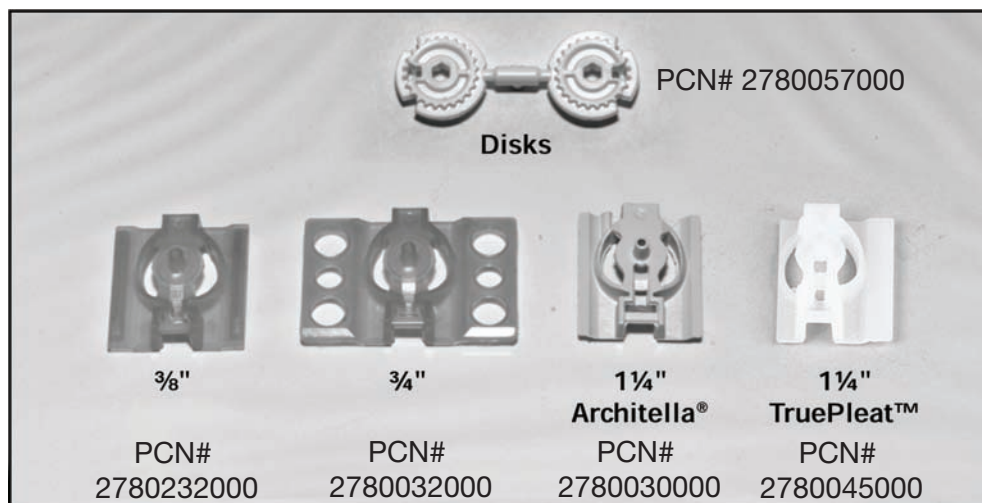

EasyAdjust™ Housings and Disks



Standard bottom rail cord path for EasyRise®, LiteRise®, PowerRise® and UltraGlide®.

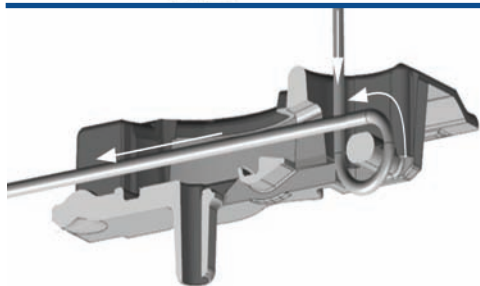

Top-Down and Top-Down/Bottom-Up middle rail cord path for EasyRise, PowerRise and UltraGlide.

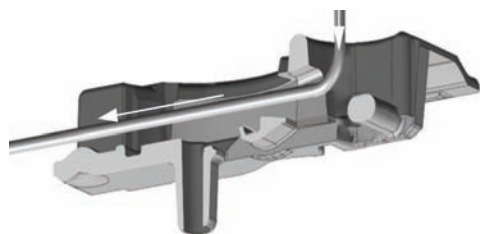

Top-Down and Top-Down/Bottom-Up middle rail cord path for LiteRise®.