

# HunterDouglas

## Luminette<sup>®</sup> PowerView<sup>™</sup> Motorization Quick Tips

### Installation

#### Mounting the Brackets

- Mount the brackets 5" in from each jamb for inside/ceiling mount and 5" from the end of the headrail for outside mount.
- If more than two installation brackets are required, mount the additional bracket(s) spaced evenly between the two end brackets.

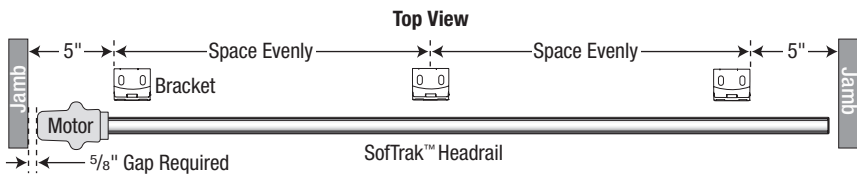

**CAUTION:** Installation brackets should be fastened into wood whenever possible. Use drywall anchors when mounting into drywall. When attaching brackets into drywall, additional brackets may be required to keep the headrail level after the fabric is attached.

#### Remove the Motor Assembly

- Unplug the motor's power cable from the extension cable to the DC power supply.
- There are two methods for removing the motor shown on the following page. Choose the one that works best for you.

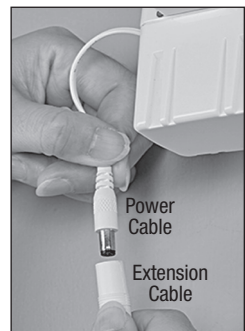

## INSTALLATION

- **Method 1:** This method works best when the fabric has been removed from the headrail.

Insert the screwdriver into the slot on the drive assembly. Twist about one-fourth turn to release the spring-latch, and pull down gently on the motor assembly to separate.

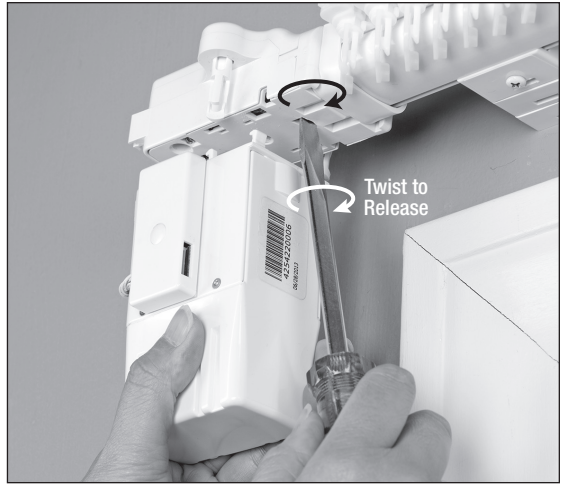

- **Method 2:** This method works best when fabric is still installed on the headrail.

Insert a hex key into the side slot on the drive assembly (either front or back) to release the spring-latch, then pull down gently on the motor assembly to separate.

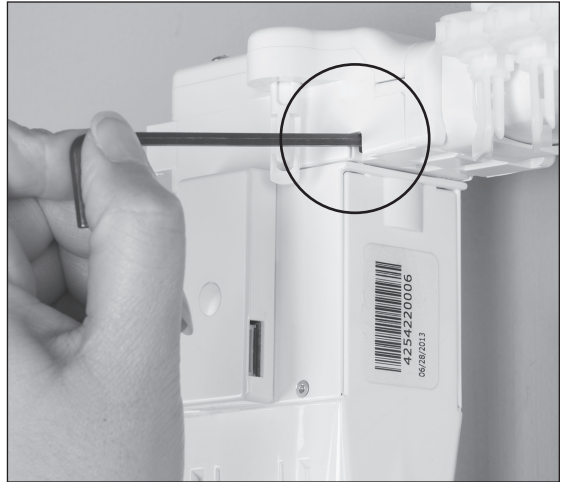

## Connect PowerView™ Components

### Connect the Motor Assembly

- Align the pins with the holes in the drive assembly. Press the motor up into the drive assembly until it clicks into place.

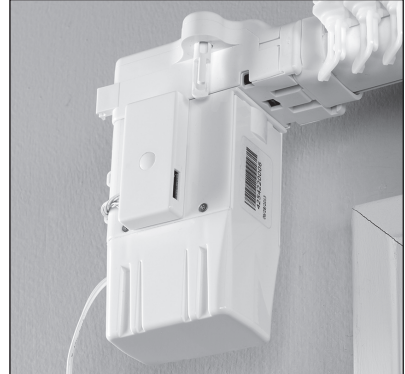

**IMPORTANT:** If snapping the motor onto the drive assembly seems difficult, grasp the lead carrier and pull the carriers slightly away from the motor, as shown at right. The motor should now snap in easily.

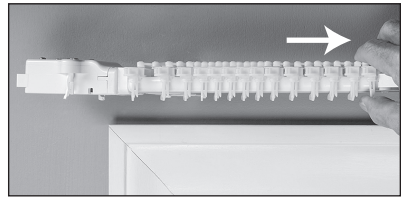

- If you remove the motor and need to reinstall it, check the drive assembly and make sure the tilt gear aligns with the arrows.
  - If necessary, use a screwdriver to turn the tilt gear until it is aligned.

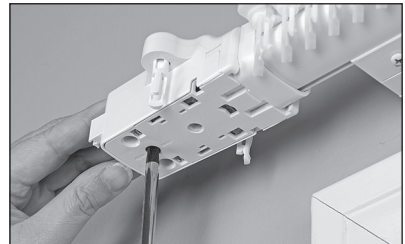

## INSTALLATION

### Connect the DC Power Supply

**NOTE:** When power is connected to the motor, a green LED inside the manual control button housing will flash to indicate the shear is ready for operation.

- Plug the power cable from the motor into the extension cable.
- Plug the other end of the extension cable into the DC power supply.
- Secure the extension cable using the C-clips provided. Hide the cable behind the fabric, making sure it does not impede operation.
- Space the C-clips approximately 15" apart along the extension cable, as shown.
- Plug the DC power supply into the power source.



**WARNING:** Keep cables and small parts out of the reach of children. They can wrap cables around their necks and **STRANGLE**. They can also put small parts in their mouths and **CHOKE**.



**WARNING:** Electric shock and/or a fire hazard may occur if not properly installed.

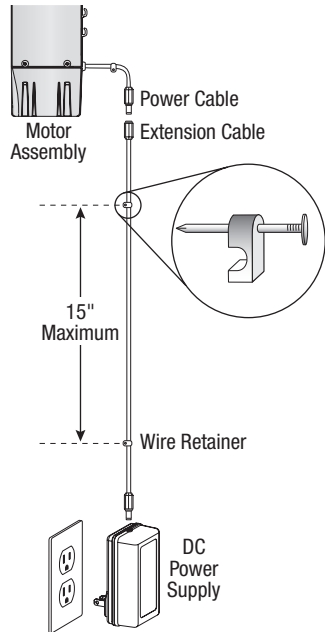

## Test Headrail Operation

- Use the manual control button on the motor to test the operation of the headrail, following the sequence below.

1. Press and hold the manual control button for 6 seconds. The sheer will move slightly.
2. Release the manual control button. The sheer will move to its fully open position to set the OPEN travel limit, then move to the fully closed position to set the CLOSE travel limit. Next, the vanes will rotate counter-clockwise and then clockwise to set the rotation limits. The sheer will move slightly one more time to indicate that the travel limits have been set.



**NOTE:** There could be up to an 8 second pause between the vanes tilting from counter-clockwise to clockwise.

- Pressing the manual control button while the carriers are traversing or the pinion clips are rotating will stop the action. The next button press will traverse the carriers or rotate the pinion clips in the opposite direction.

## Using the PowerView™ Remote

First, activate the remote by pulling both plastic tabs from the back battery compartment.

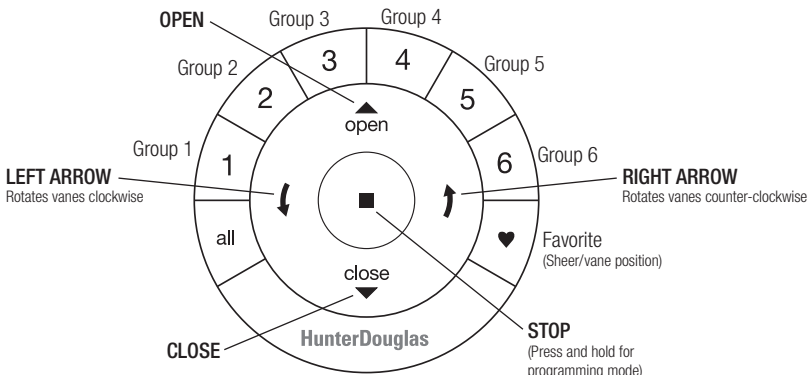

**IMPORTANT:** If you have more than one remote, see “Adding Additional Remote(s) to the PowerView™ Shade Network” in the *PowerView Motorization Remote Control Guide*.

## OPERATION

---

### Joining a Sheer to a Group

**IMPORTANT:** The sheer will not operate using the remote until it has been joined to a group.

1. Press and hold ■ STOP for 4 seconds to put the remote in program mode. The lights on the remote will flash to indicate it is in program mode.
2. Press the desired group number (1 – 6) on the remote. The light for the group number will flash to show it is selected.
3. Press and hold the manual control button on the motor.
4. While continuing to press the manual button, press ▲ OPEN on the remote. The sheer will move slightly to indicate it has joined the group. Release the manual control button.
5. Press and hold ■ STOP for 4 seconds to exit program mode. The lights will stop flashing.

### Basic Operation

1. To wake up the remote, simply pick it up or press ■ STOP. The last group(s) selected will be highlighted and active.
2. Press “all” or groups 1 – 6 to select the specific sheer(s) to operate. The group button(s) will light to show they are selected.
  - a. Multiple group buttons may be selected at a time.
  - b. To deselect a group, press the group number again. The light for that group button will go out.
3. Press ▼ CLOSE to traverse the selected sheer(s) closed, covering the opening.
4. Press ▲ OPEN to traverse the selected sheer(s) open, uncovering the opening.
5. Press ■ STOP to stop the sheer’s movement anywhere along its travel.
6. Press the ↗ right arrow to rotate the vanes counter-clockwise. (If the sheer is not already drawn closed, pressing this button will close the sheer first and then rotate the vanes.)
7. Press the ↙ left arrow to rotate the vanes clockwise. (If the sheer is not already drawn closed, pressing this button will close the sheer first and then rotate the vanes.)
8. Press ■ STOP to stop vane movement.
9. Press ♥ FAVORITE to send the selected sheer(s) to a preset position. Refer to the *PowerView™ Motorization Remote Control Guide* on how to set a favorite position.

## **Further Operation and Programming Information**

### **PowerView™ Pebble™ Remote and/or PowerView Surface Remote Operation**

For information regarding operation and programming of the PowerView remote, refer to your *PowerView Motorization Remote Control Guide*.

### **PowerView Scene Controller**

For information regarding operation and programming of the PowerView Scene Controller, refer to your *PowerView Motorization Scene Controller Guide*.

### **PowerView App Operation**

The PowerView Hub is required for PowerView App operation. For information regarding setup and operation using the PowerView App, refer to the online *PowerView App Software Guide* at [hunterdouglas.com/powerview/support](http://hunterdouglas.com/powerview/support).

## **Resetting the Sheer**

### **Basic Reset**

The basic reset is used to set the sheer's travel limits.

1. Press and hold the manual control button for 6 seconds. The sheer will move slightly.
2. Release the manual control button. The sheer will move to its fully open position to set the OPEN travel limit, then move to the fully closed position to set the CLOSE travel limit. Next, the vanes will rotate counter-clockwise and then clockwise to set the rotation limits. The sheer will move slightly one more time to indicate that the travel limits have been set.

### **Resetting Shade Programming**

This reset erases all programming from memory, including group assignments, preventing any input device from operating the sheer. Its primary use is during installation to correct group and network assignments. This reset does not affect travel limits.

1. Press and hold the manual control button for 12 seconds. The sheer will move slightly once after 6 seconds, then again after 12 seconds. Release the button.
2. Refer to "Joining a Sheer to a Group" on page 6 to program the sheer to a group.



© 2016 Hunter Douglas.

All rights reserved. All trademarks used herein are the property of Hunter Douglas or their respective owners.

135103639



9/16