

Situo® 5 Soliris RTS Pure II

Item #: 1870579



OVERVIEW:

Situo® 5 Soliris RTS offers an ideal way to manage one or several Radio Technology Somfy® (RTS) applications, including sun function control for RTS sun sensors. Users can turn sensors on/off with the touch of a button. With a modern finish, ergonomic curves and refined silhouette, the Situo 5 Soliris broadens Somfy's vast RTS control offer even further.

FEATURES SUMMARY:

- Remotely activate or deactivate sun sensor to automatically operate window coverings with ease
- Provides control of 5 individual window coverings/sensors or 5 groups of window coverings/sensors
- "MY" button provides easy access to a preferred position
- Unique design allows for discreet wall mounting
- Compatible with entire range of RTS products

WHAT'S IN THE BOX:

- Remote (with battery)
- Instructions
- Wall mount
- Screw set



TECHNICAL SPECIFICATIONS:

- Power: 3V, CR2430 Lithium battery
- Protection Rating: IP 30
- Material: ABS
- Dimensions:
 - L: 5.35 in. (136 mm)
 - W: 1.66 in. (42 mm)
 - H: .67 in. (17 mm)
- Maximum Range: Operates reliably at 20 feet (up to 65 feet under optimal conditions)
- Operating Temperature Range: 32° to 140° F (0° to 60° C)
- Frequency: 433.42 Mhz +/- 100kHz
- Shipping Weight: 1 lb

CONNECTIONS AND INDICATORS:

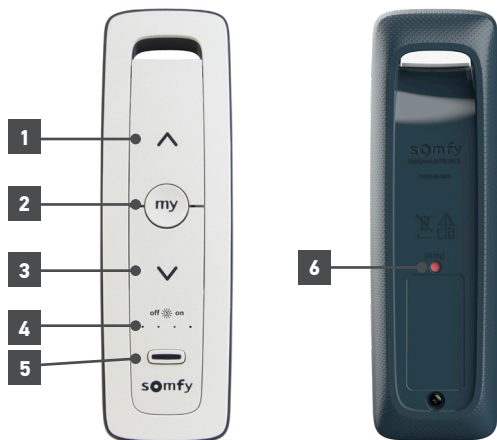

ELEMENT	FUNCTION
1 UP Button	UP directional button
2 "MY" Button	"MY" favorite position or STOP button
3 DOWN Button	DOWN directional button
4 LED Indicators	Illuminates to confirm RTS signal transmission
5 Channel Selector Button	Selects channel to operate
6 Programming Button	Used for RTS programming

DIMENSIONS:

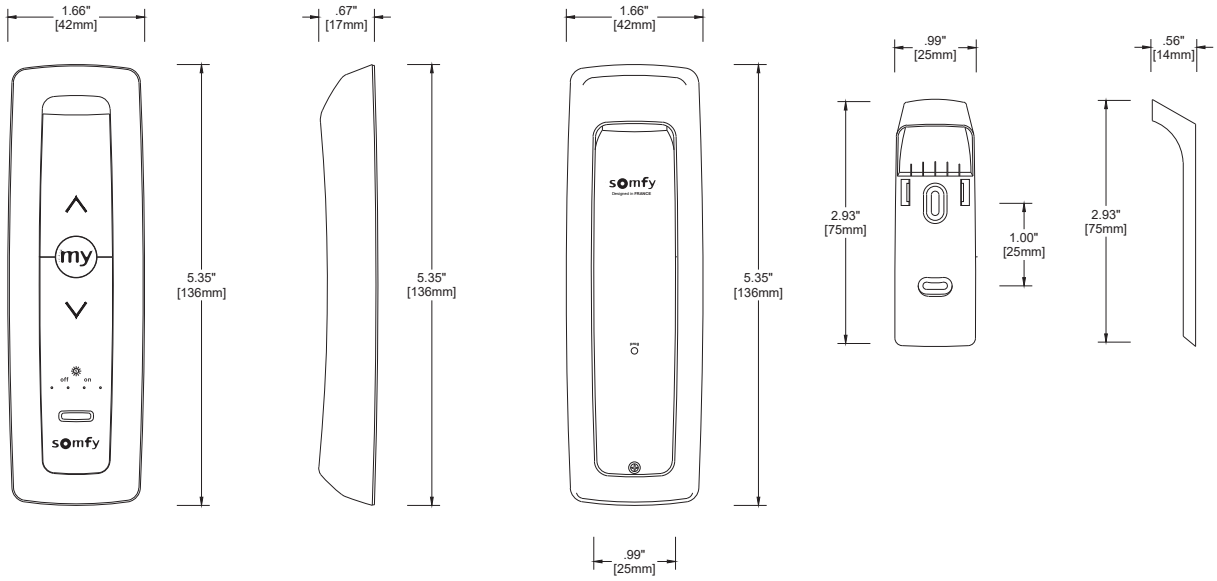

BEST WIRING PRACTICES

The diagram shown below is meant for illustrative purposes to show the connections from product to product. This device could be used in other configurations than shown below. For specification information on individual products, see related product information.

